

TUFLOC

INSTALLATION INSTRUCTIONS

Ford Interceptor TufBox

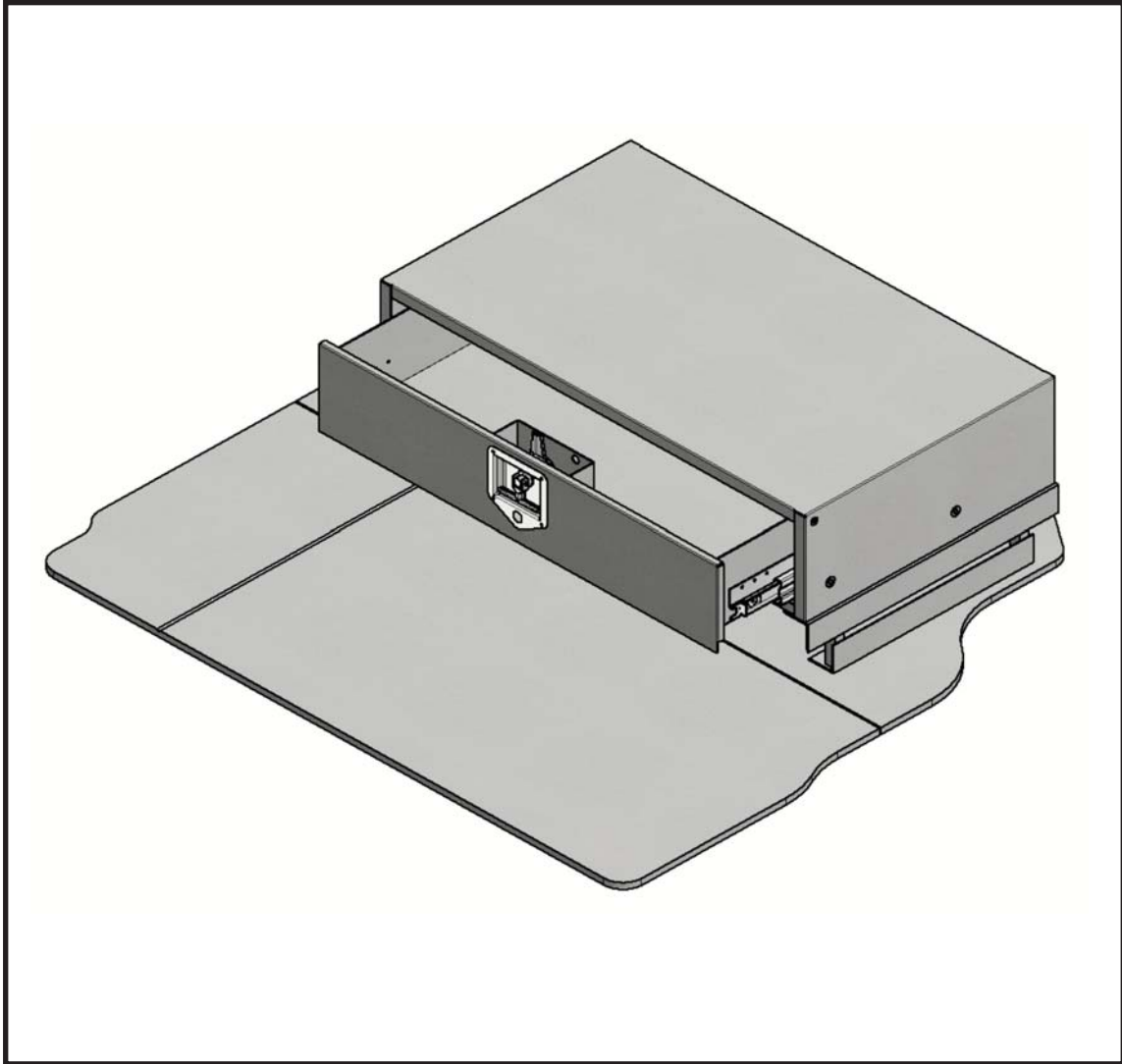

Warranty

Thank you for purchasing the TufBox manufactured by TUFLOC. We have worked hard to develop the best storage box on the market and warrant this product for one year from date of purchase against defects in materials and workmanship. This warranty is limited to replacement or repair of the product only. No other warranties are expressed or implied. Please contact the factory for warranty claims before returning any product.

Installation

1. Remove the drawer from the cabinet by removing the Slide Securing Screws located on each side of the drawer. Next, while pressing in on the Retaining Tabs located on the sides of the drawer, lift up on the front of the drawer, removing it from the tabs and pull it away from the cabinet. (See Detail A below)

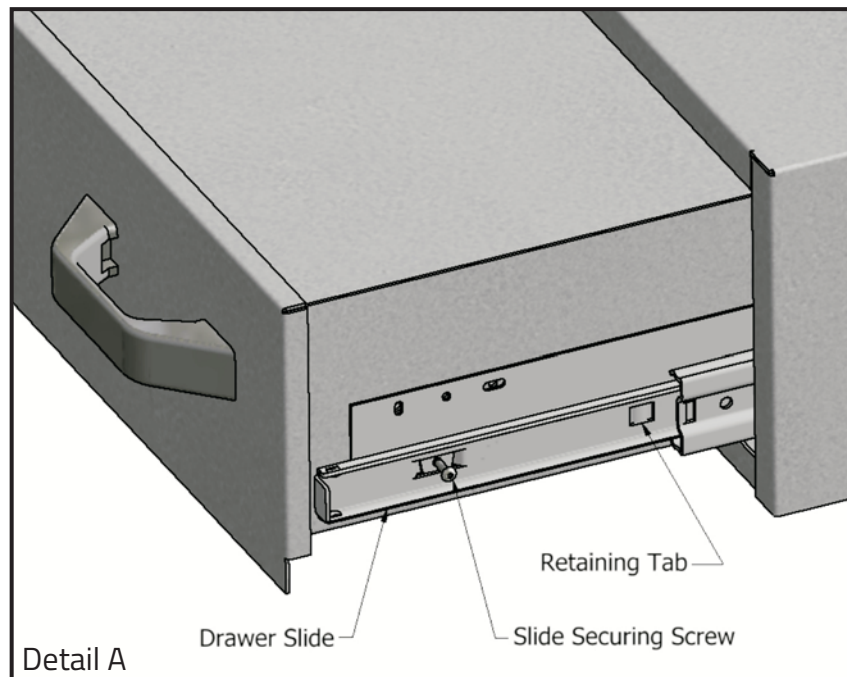

2. Remove the hard rubber trunk mat from the trunk compartment. Mark a line 22" from the back of the mat nearest the break lights. Using a hack saw, cut the trunk mat at the 22" line. Place the smaller half back into the back of the trunk compartment. The front half will be used at the end of the installation. (See diagram below)

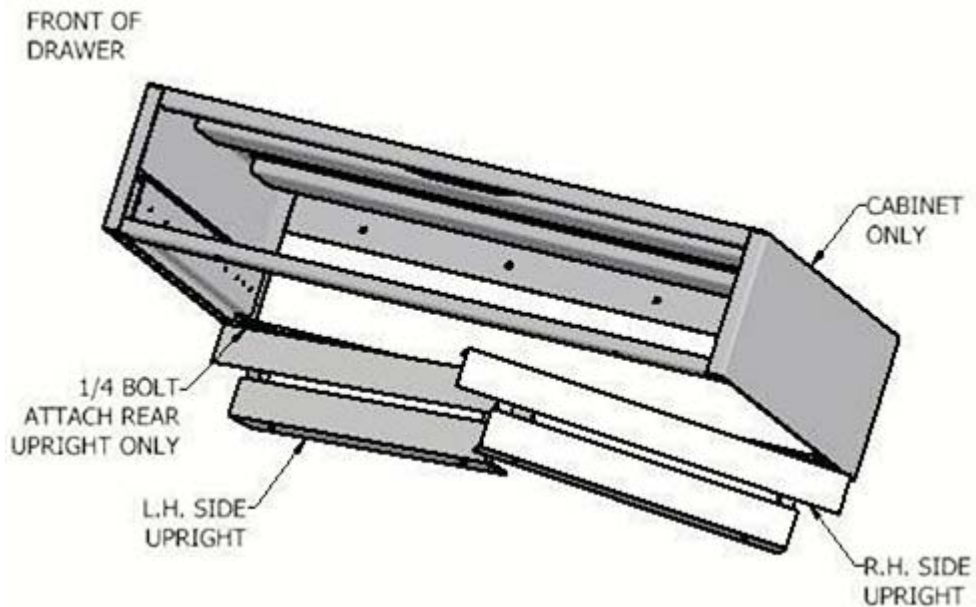
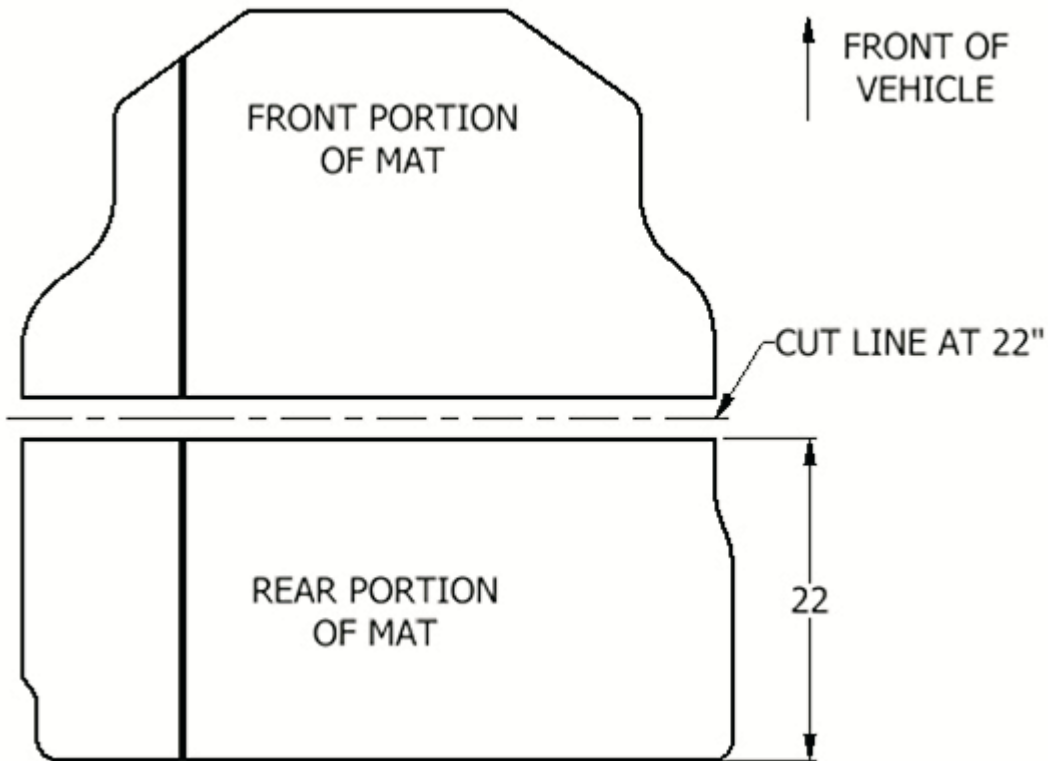

4. Slide the cabinet assembly all the way to the back of the trunk compartment and position the assembly between the wheel walls. Swing the uprights outward and attach them to both sides of the cabinet using 1/4" bolts. (See diagram below)

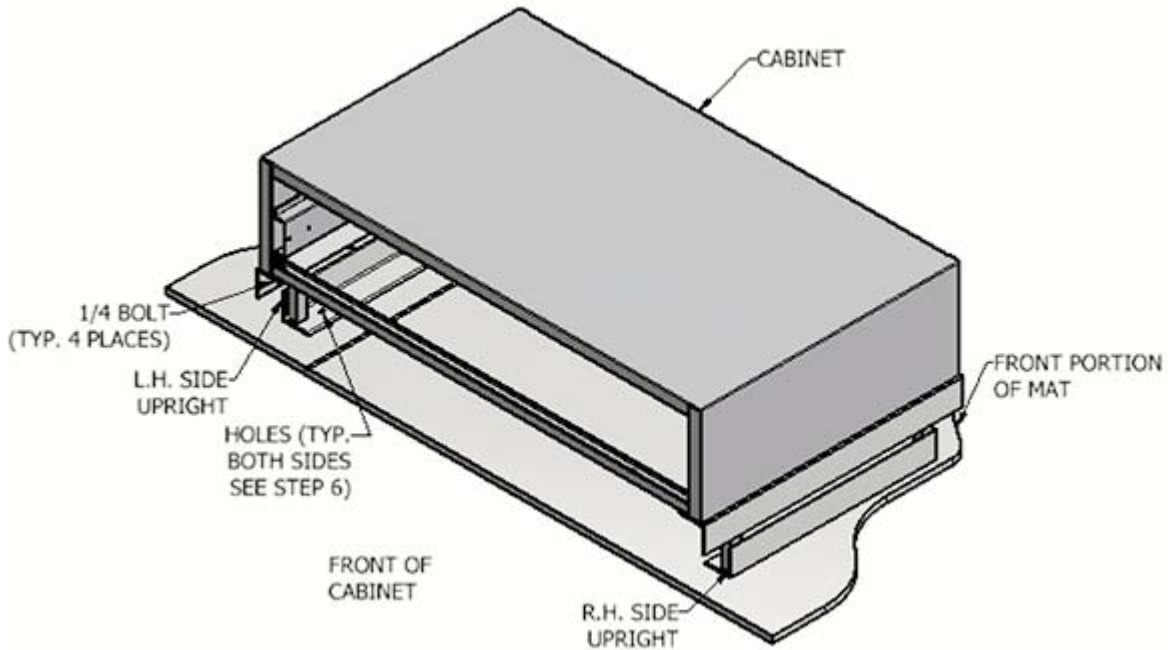

5. Locate the four holes on the back panel inside the cabinet assembly. Mount the cabinet assembly, through either hole to back metal framework vehicle, using at least one of the self-tapping screws supplied. (See diagram below. Uprights have been omitted for clarity.)

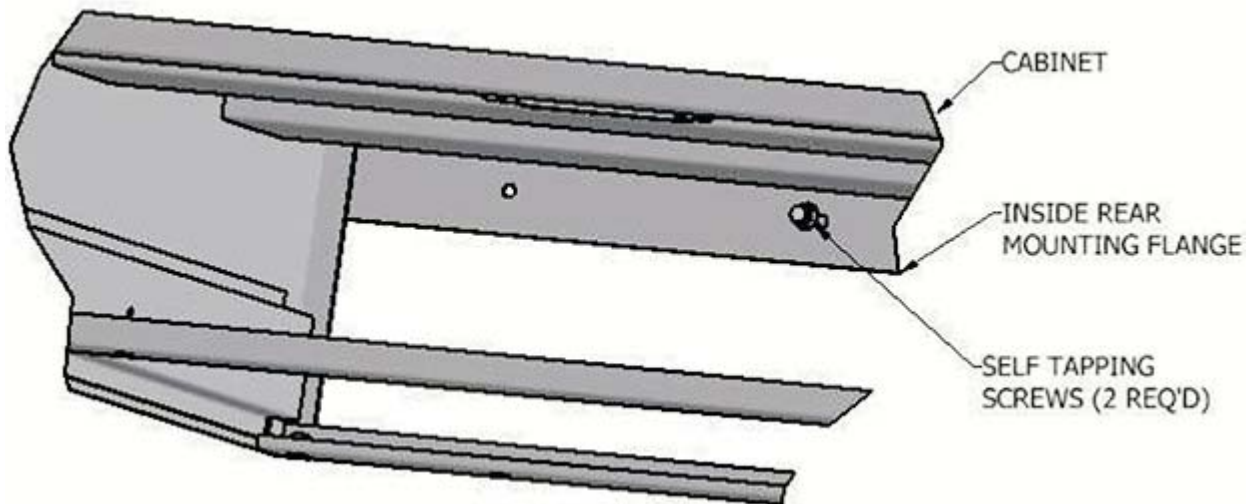

6. Locate the holes on the bottom of the uprights and use a self-tapping screw on each side to secure them to the trunk mat. **Because of the gas tank location, wiring, hoses, etc, it is recommended that there be no additional drilling in the mounting zones.** (See diagram below. The drawer has been omitted for clarity.)

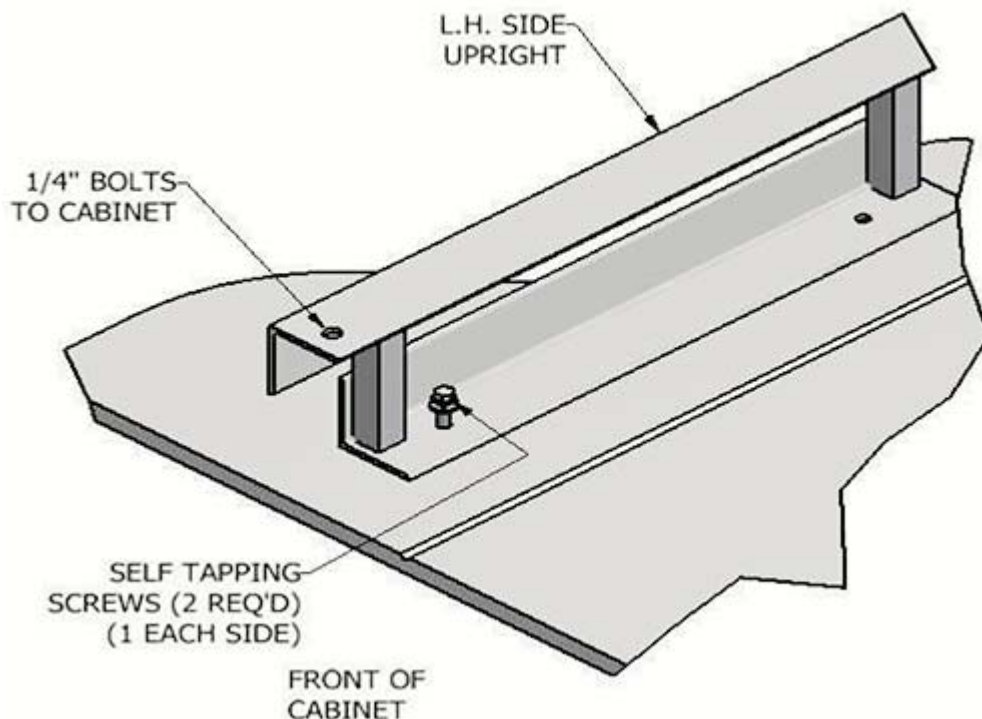

Place Drawer into the Cabinet

Place the drawer back into the cabinet by extending the drawer slides and snapping the rails on the Retaining Tabs. You may need an assistant to help align the tabs over the drawer slides. Install the Slide Securing Screws on each side of the Drawer. (See Detail A on Page 2.) Place the left over front half of rubber trunk mat back into the trunk compartment. The mat should fold and remove for access of the spare tire.

Make Sure the Drawer Functions Properly

Open & close the cabinet drawer to make the sure the drawer is firmly attached to the slides. If the drawer is not firmly attached, remove the drawer, bend the silver tabs outward and replace the drawer.

Maintenance

- These drawers are intended to hold a maximum weight of 200 lbs. Do not exceed the drawer weight limit. Exceeding the weight limit can make the drawer difficult to operate and can shorten the life of the bearings in the drawer slides.
- The TufBox is designed to provide years of reliable service with minimal maintenance. Occasionally, coat the key with a light petroleum-based lubricant such as WD-40 and insert the key into the lock & turn a few times to lubricate the lock cylinder. NEVER use a graphite based oil. The drawer slides should also be lubricated periodically to assure longer life.
- Standard T-Handle: An adjustable cam can be adjusted to keep the drawer tight and eliminate rattle. (See diagrams below)
- Premium T-Handle: An adjustable roller can be adjusted to keep the drawer tight and eliminate rattle. (See diagrams at left). The Premium T-Handle has the ability for additional security to have a padlock added to the handle (Supplied by others).
- Combination Lock: Please refer to enclosed instruction booklet.

